

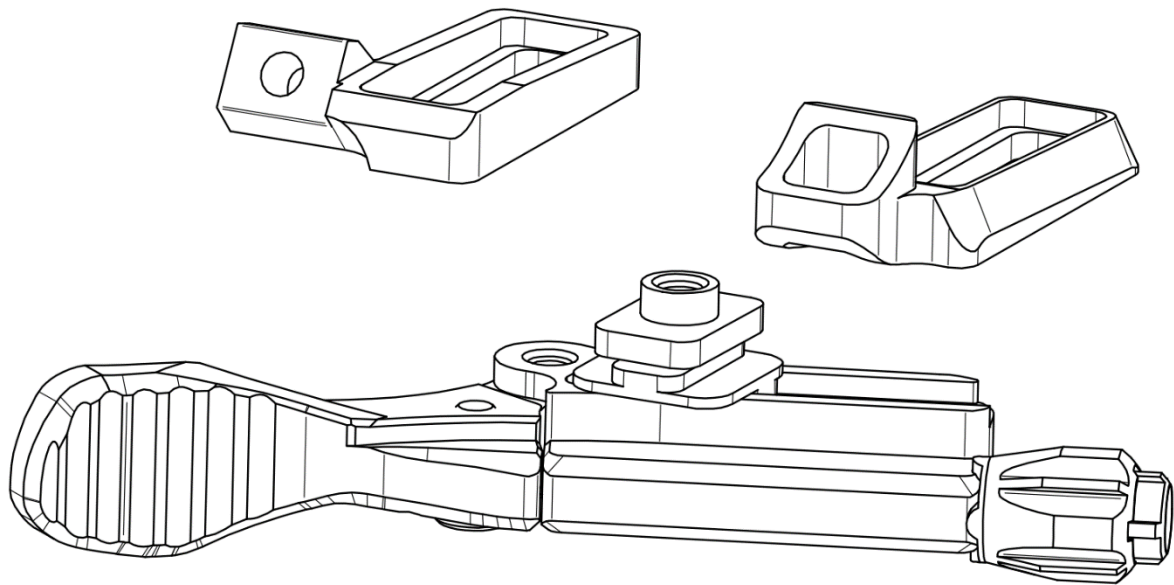

EIGHTPINS



Installation instruction Underbar Remote

V1 en 17.11.2023
Underbar Remote

Lupaan GmbH
Kristein 2
A-4470 Enns
www.eightpins.at
service@eightpins.at

For optimal functioning of the Underbar Remote, correct installation according to the following steps is necessary.

CAUTION: For installation on the attachment points of the respective Matchmaker, these must already be present or purchased separately! (e.g., Avid Matchmaker X Clamp Adapter, Magura Shiftmix) For I-Spec installation on SHIMANO brake levers, only a SHIMANO fixing nut (Part No.: Y-0FB50000) needs to be purchased separately!

Installation instructions

Tools required

- 4mm Hex key
- 3mm Hex key
- 2mm Hex key
- Torque wrench with 3mm and 4mm hex attachment
- Bowden cable cutter or side cutter

Preparation

Install the seat post in the frame at the correct seat height, route the Bowden cable housing inside or on the frame, leading it towards the handlebars. Ensure that the Bowden cable housing is long enough to ensure a 90° handlebar turn. If necessary, trim the Bowden cable, or pull in a new Bowden cable.

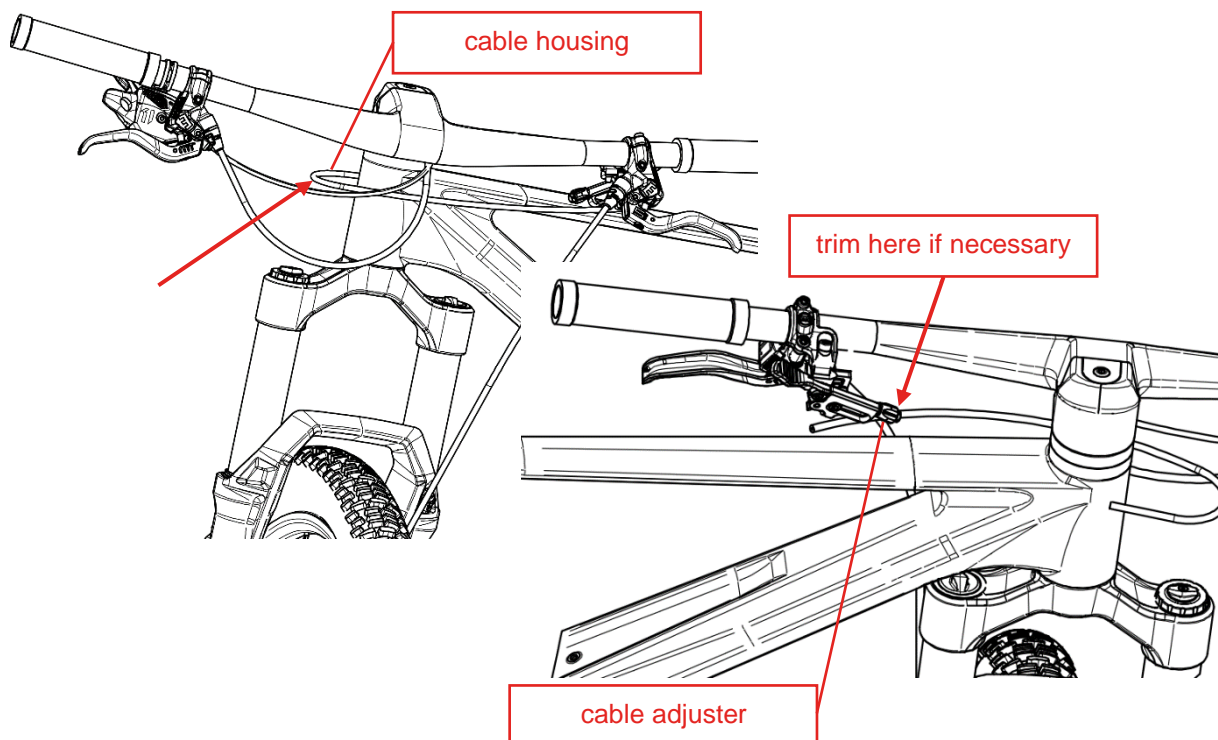

Install the Matchmaker according to the manufacturer's instructions.

Exception: SHIMANO fixing nut must be oriented downward!

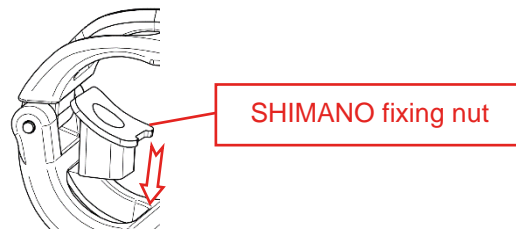

Step 1: Assemble the adapter for installation in the shown arrangement and tighten the screw only slightly. Ensure that the Cross-Plate is inserted at the correct angle.

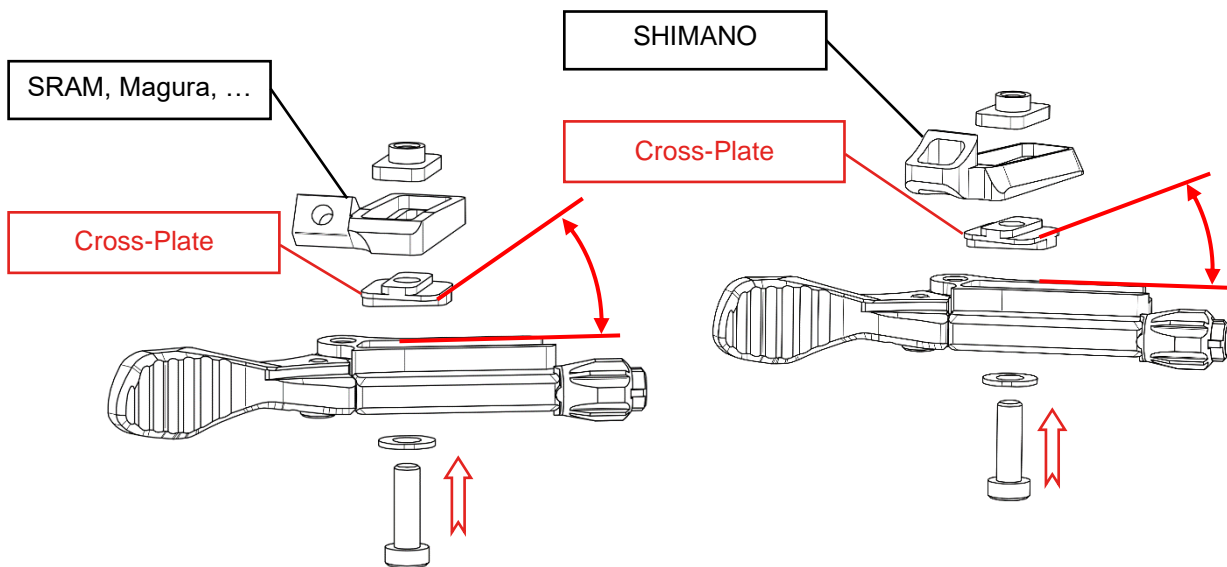

Step 2: Screw the remote with the attached adapter onto the Matchmaker initially slightly.
 The remote must be movable in all directions on both the Matchmaker and the adapter.

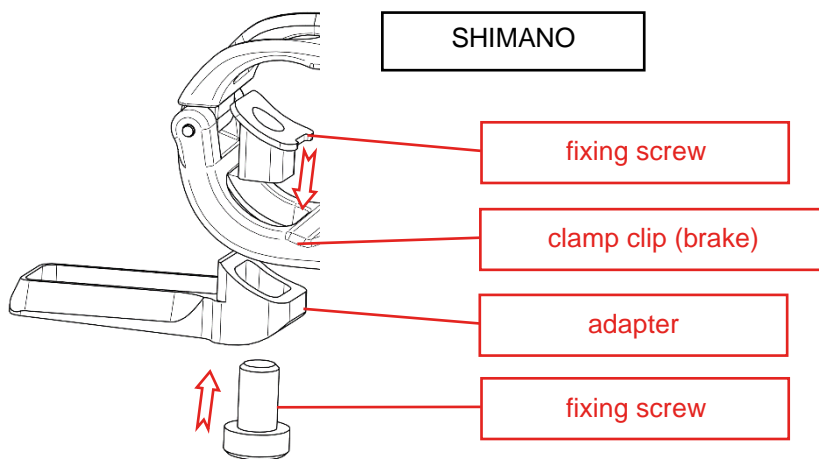
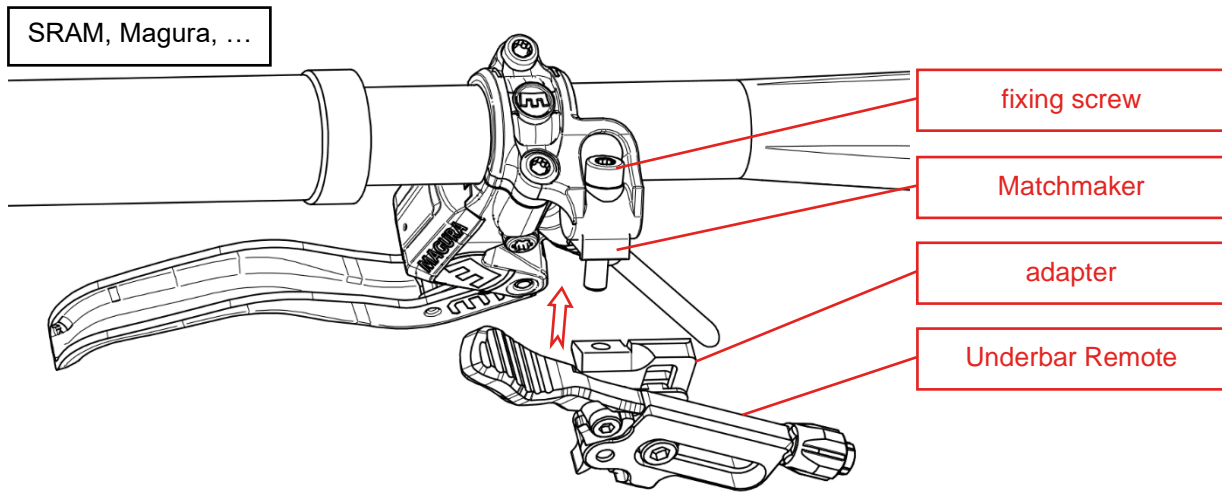

Step 3: Find the desired position by placing your hand on the grip in a riding position. Place your thumb on the „pressure area” of the lever and adjust to the perfect position. Then tighten the Matchmaker mounting screw to the manufacturer's specified torque. Tighten the screw connecting the Underbar Remote to the adapter with a 4mm Hex key to 2.5 Nm.

The description is identical for all Matchmaker systems!

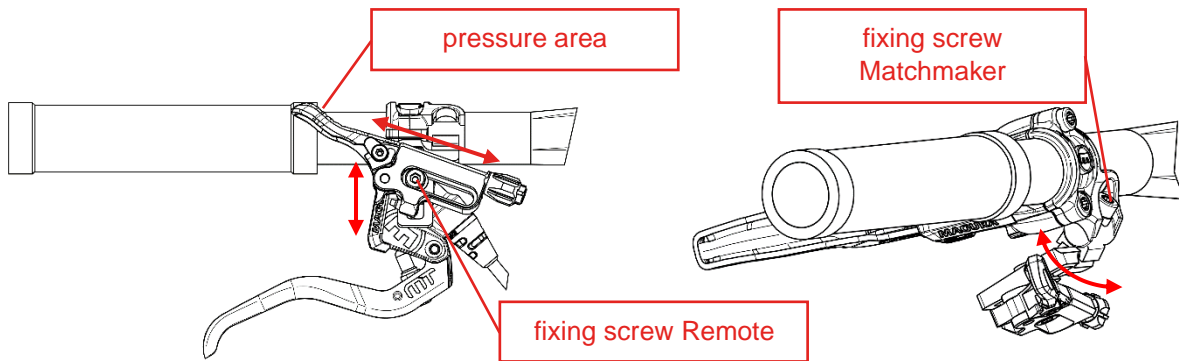

Step 4: Screw the cable adjuster all the way in. Open the clamping screw for the Bowden cable so that the cable can be threaded.

The description is identical for all Matchmaker systems!

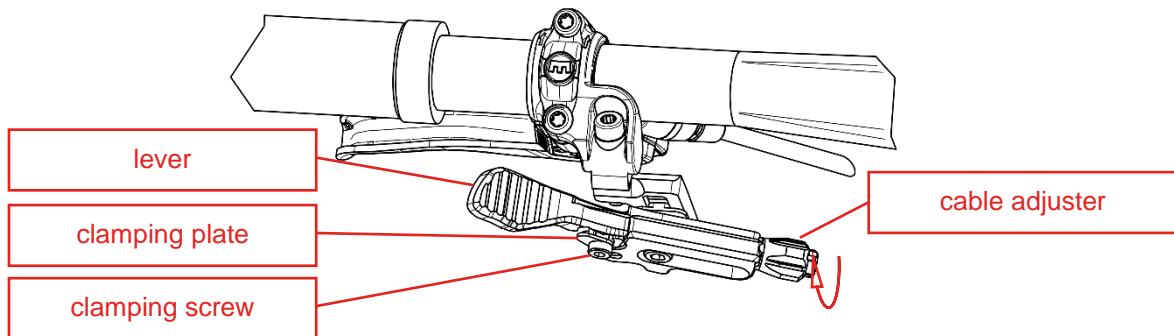

Step 5: Attach the end cap to the cable housing and thread the bowden cable through the remote.

The description is identical for all Matchmaker systems!

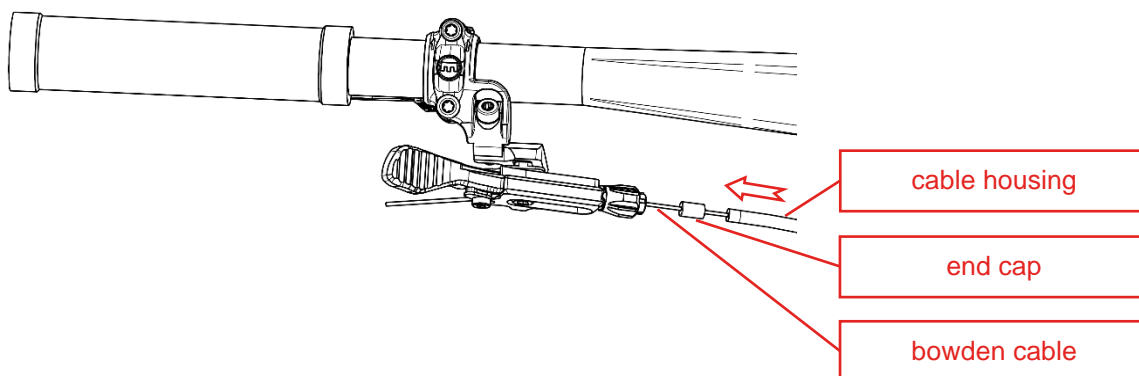

Step 6: Thread the bowden cable between the lever and clamping plate and insert the cable housing into the cable adjuster. Ensure that the lever is in the NOT-pressed position. Tighten the clamping screw under slight tension on the bowden cable to 1.5 Nm.

The description is identical for all Matchmaker systems!

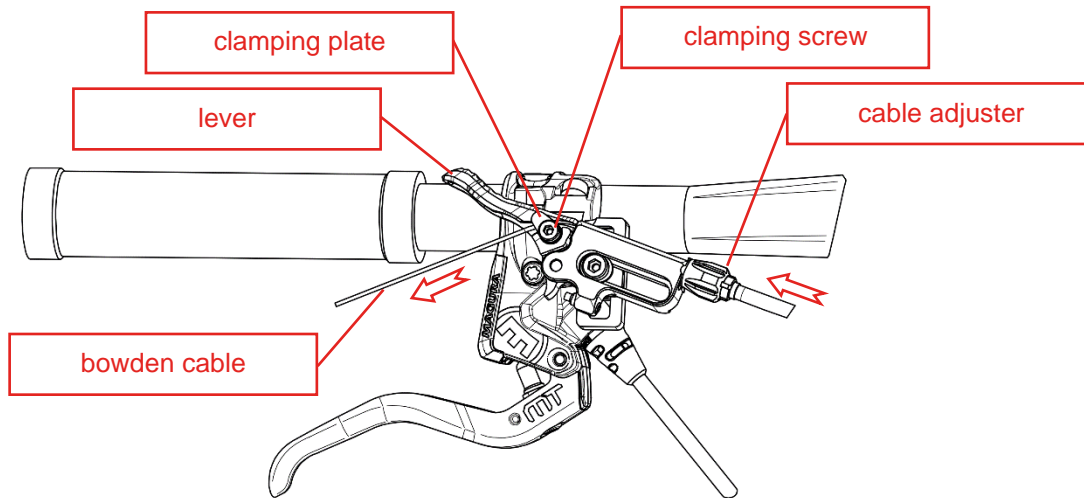

Step 7: Open the cable adjuster until there is no free play felt at the remote lever.

Info: If the cable adjuster is already fully open and there is still free play at the lever, the cable adjuster must be completely screwed in again. Open the clamping screw again and tighten the bowden cable. Tighten the clamping screw under slight tension on the bowden cable to 1.5 Nm.

The description is identical for all Matchmaker systems!

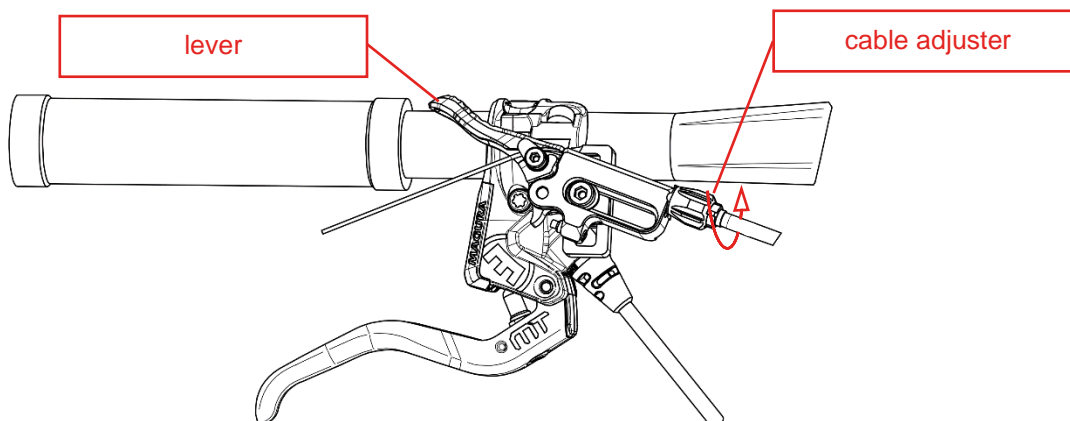

Step 8: the protruding bowden cable within the lever length using a cable cutter.

The description is identical for all Matchmaker systems!

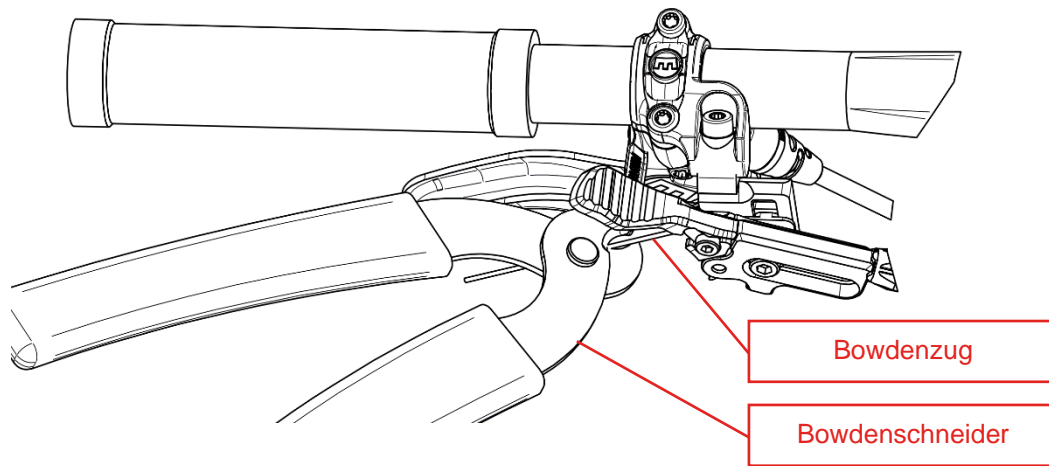

Step 9: To avoid tension on the seat post, adjust the lever limit screw.

Slowly press the remote lever until the seat post lock is engaged. Use a 2mm Allen key to tighten the limit screw until the previously determined lever position is reached.

The description is identical for all Matchmaker systems!

