

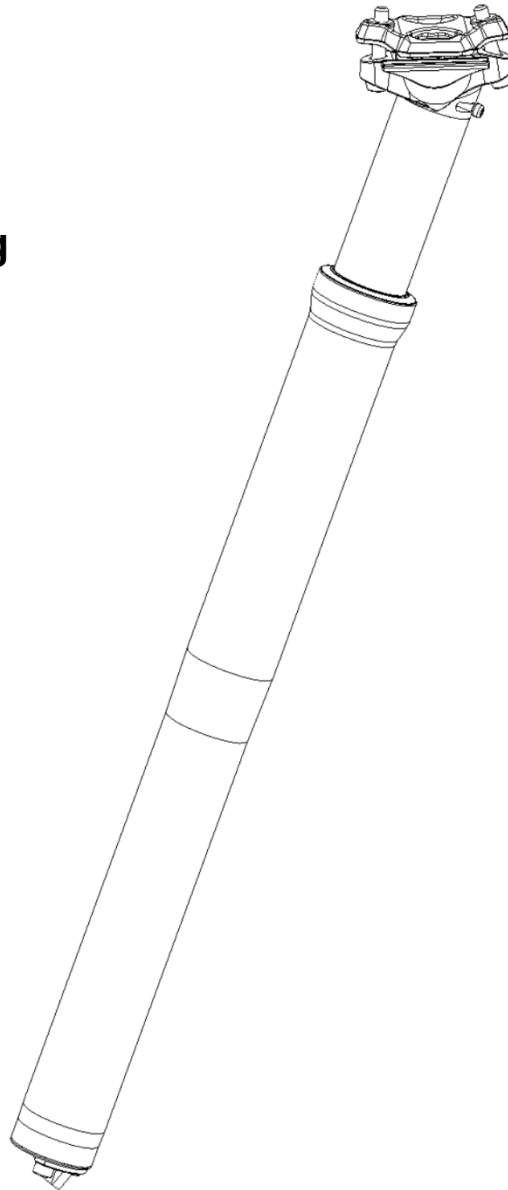

Installation and Operating

Eightpins CARGO 40 Telescopic Seatpost



**PLEASE READ CAREFULLY BEFORE
USE!**

**KEEP THIS MANUAL FOR FUTURE
REFERENCE.**

V1 en 20.03.2025
CARGO 40

Lupaan GmbH
Kristein 2
A-4470 Enns
www.eightpins.at
service@eightpins.at

General Information	2
Warranty and Guarantee	2
Use and Application	2
Service	2
Safety Instructions.....	3
Installation and Maintenance.....	3
Modifications	3
Component Overview	4
Installation	5
Mounting the End Cap and Bowden Connector	6
Installing the Seatpost in the Frame.....	7
Saddle Installation	8
Adjusting Saddle Tilt.....	9
Operation	10
Adjusting Saddle Height	10
Maintenance	14
Cleaning the Wiper and Felt Ring	14



General Information

Thank you for equipping your bike with an Eightpins telescopic seatpost. There are several important points to consider when handling the Eightpins seatpost. It is crucial to observe the maximum extension lengths and required insertion depths.

Caution! Incorrect operation may result in injury or damage to the frame or seatpost.

Always ensure that all adjustment elements are properly engaged and the cable tension is correctly set. If you lack the necessary skills for installation, contact your dealer or the service center in your country.

Caution! Read the following installation and operating instructions carefully step by step and install the Eightpins seatpost according to each step.

Warranty and Guarantee

Your new Eightpins CARGO 40 seatpost comes with a one-year warranty and a two-year guarantee from the date of purchase. All moving parts of the mechanism and the hydraulic gas spring are wear parts. The warranty and guarantee explicitly cover repair or replacement. Proof of purchase is required to verify warranty claims. Normal wear and tear, routine maintenance, collisions, or improper installation or use of the seatpost are excluded from warranty coverage. Any modifications to the seatpost will void the warranty. The user assumes responsibility for any personal injury or property damage, including damage to the seatpost and other consequences arising from modifications or improper use of the seatpost.

Use and Application

The intended use of the system is installation in a suitable bicycle frame. The seatpost is designed to adjust the height of the saddle within the range specified by the product. Modifying the system or installing it in unsuitable bicycle frames is not permitted.

The system is not suitable for children under 12 years old due to the risk of pinching.

Keep the seatpost away from children and store it out of their reach.

The product is intended for private use only.

It is not approved for competitions.

It may only be used by one person without physical limitations and who is familiar with this manual.

The product must only be used by a person seated on the bicycle.

Service

The Eightpins seatpost has the advantage that the seatpost tube can be installed and removed very quickly and that the bushings can be cleaned or replaced quickly. If the sliding performance deteriorates, the seatpost can be quickly lubricated.

Minor tasks, such as cleaning and lubricating the bushings or replacing the cable, can be carried out by following the manual, provided you have the necessary technical understanding and proper tools.

The following tasks should be performed regularly:

	Before every ride	Every 120 operating hours	Every 240 operating hours
Remove dried dirt with water and mild soap	X		
Fill felt ring with oil		X	
Clean the wiper		X	
Clean bushings		X	
Replace bushings			X
Replace wiper			X
Replace felt ring			X
Lubricate longitudinal guide grooves			X

Detailed steps for these maintenance tasks can be found in the "Service" chapter. Your bicycle manufacturer, a trained specialist dealer, or Lupaan GmbH is responsible for the service of your Eightpins seatpost:

Lupaan GmbH „EIGHTPINS“
 Kristein 2
 4470 Enns
www.eightpins.at
service@eightpins.at

Caution: Do not attempt to service the gas spring yourself. The system is under pressure. Risk of injury.

Safety Instructions

Intended Use

The Eightpins seatpost is designed for use in bicycles with 40mm seat tubes. The intended area of use includes city and cargo bikes. Frames not specified by the manufacturer should never be modified for this purpose. The Eightpins seatpost must only be used with Eightpins control levers. Incorrect leverage ratios or lever strokes can damage the mechanism and possibly cause irreparable damage.

Installation and Maintenance

Installation and maintenance of the Eightpins seatpost require specific technical understanding. Do not overestimate your technical abilities. Have installation and maintenance work carried out at a specialist bicycle workshop or by an authorized Eightpins service partner. Only there is proper execution guaranteed.

Modifications

The Eightpins seatpost is not intended to be modified by users. Do not carry out any work or alterations (e.g., disassembling, machining, grinding, painting) that are not explicitly described in this manual. Use a torque wrench that is calibrated for the required torque when specified. Read the instructions thoroughly and follow all steps carefully.

Caution! An incorrectly installed seatpost can lead to failure. There is a risk of falls and injury. Additionally, the frame into which the seatpost is installed may be damaged.

Component Overview

1. Eightpins seatpost tube
2. Outer tube
3. Eightpins capsule
4. Bushings
5. Wiper
6. Outer sealing ring
7. Felt ring
8. Lower saddle clamping plate
9. Upper saddle clamping plate
10. Fastening screw
11. Height adjustment actuator
12. Bowden connector

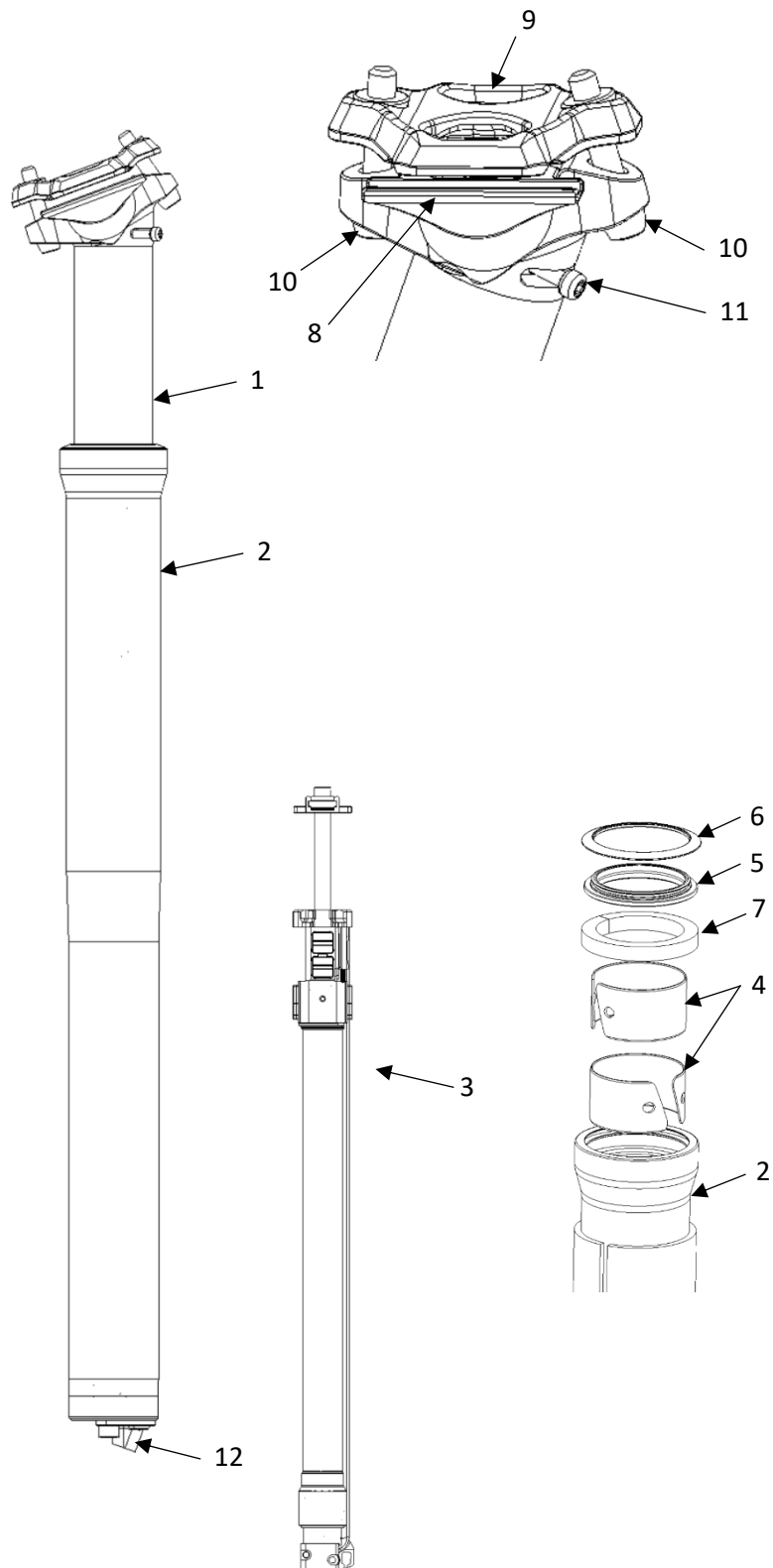

Figure 1

Installation

For the Eightpins CARGO 40 seatpost, a Bowden cable housing must be routed from the handlebar through the frame into the seat tube. The housing length should be chosen so that one end reaches the Bowden connector of the installed seatpost, and the other end reaches the handlebar remote. Ensure the Bowden cable housing is long enough to allow for a 90° steering angle.

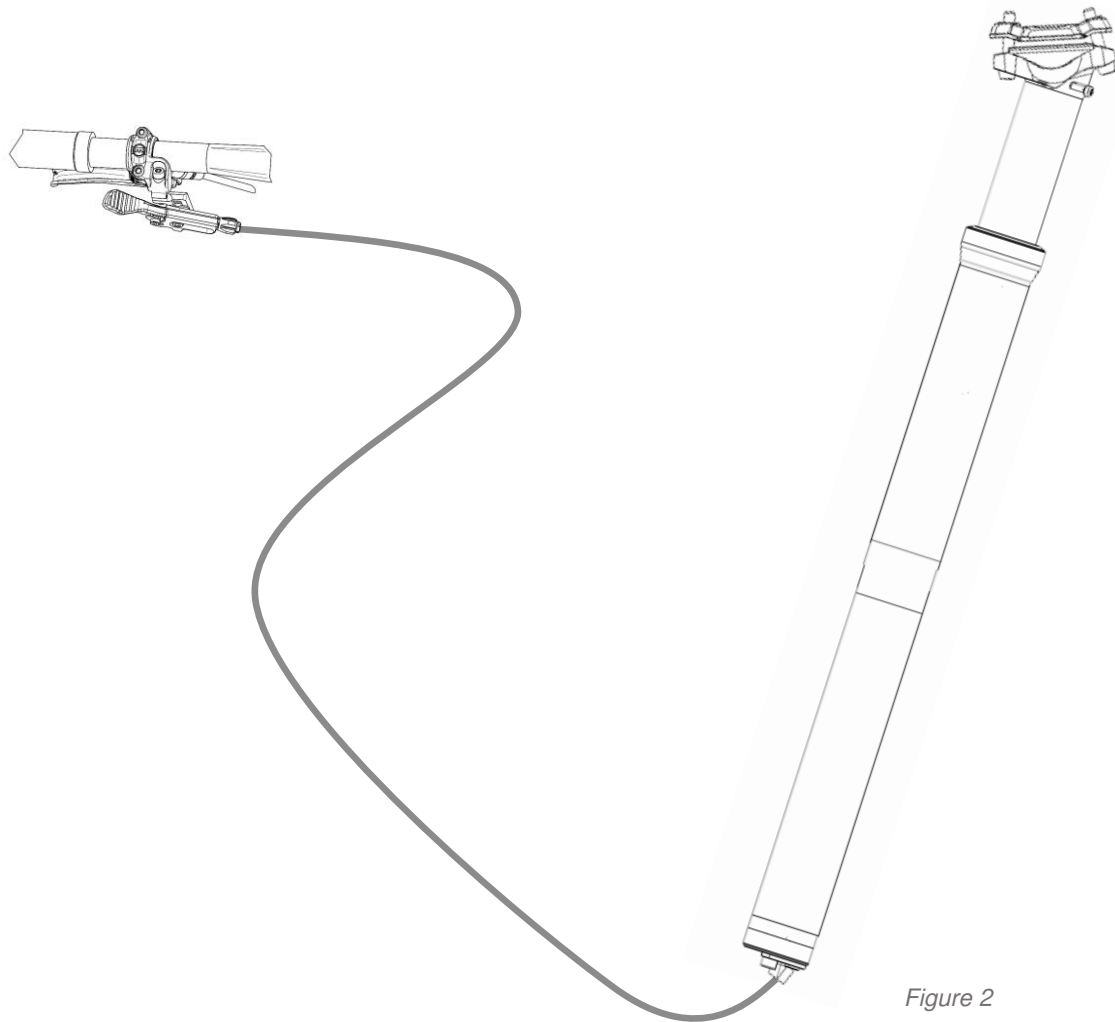

Figure 2

Once the Bowden cable housing has the correct length, feed it through the seat tube so that it protrudes approximately 20mm above the seat tube.

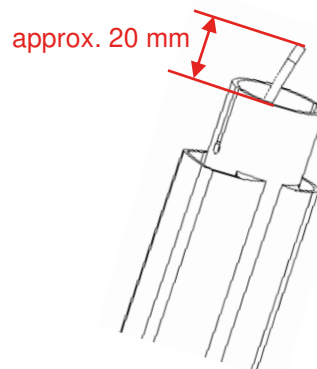

Figure 3

Mounting the End Cap and Bowden Connector

Using a 4mm Allen key, remove the screw marked in Figure 4. Remove the Bowden connector and, together with the end cap, attach them onto the Bowden cable housing in the order shown in Figure 6.

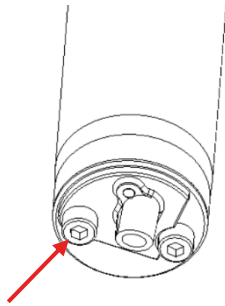

Figure 4

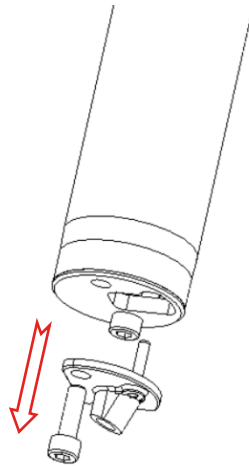

Figure 5

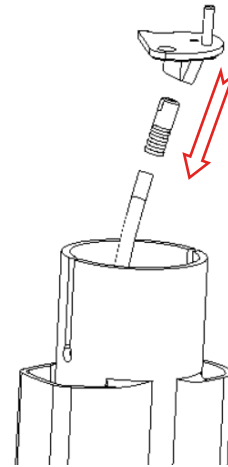

Figure 6

Thread the cable through the Bowden connector and end cap into the Bowden cable housing.

Hook the cable head into the lever (see Figure 8). Ensure that the cable remains hooked until the Bowden connector is secured.

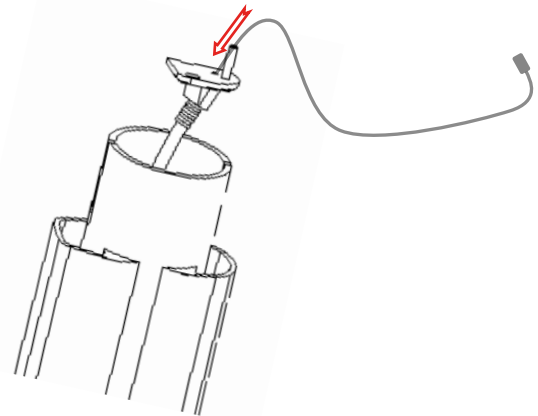

Figure 7

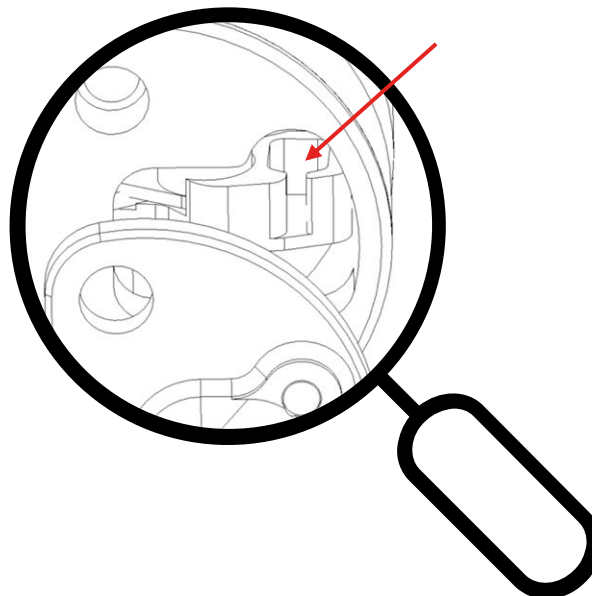

Figure 8

Use a 4mm Allen key to fix the Bowden connector with the screw. Be sure to apply medium-strength threadlocker to the screw.

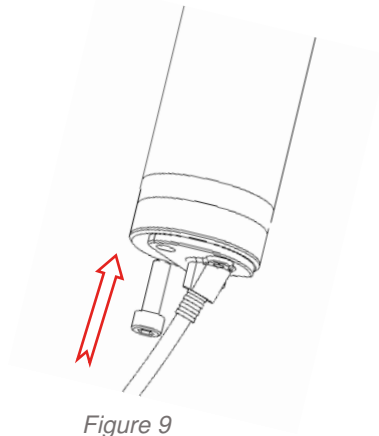

Figure 9

Installing the Seatpost in the Frame

Clean the inside of the seat tube with a cloth. No assembly grease is required inside the seat tube. Now insert the seatpost into the seat tube while simultaneously pulling on the Bowden cable housing.

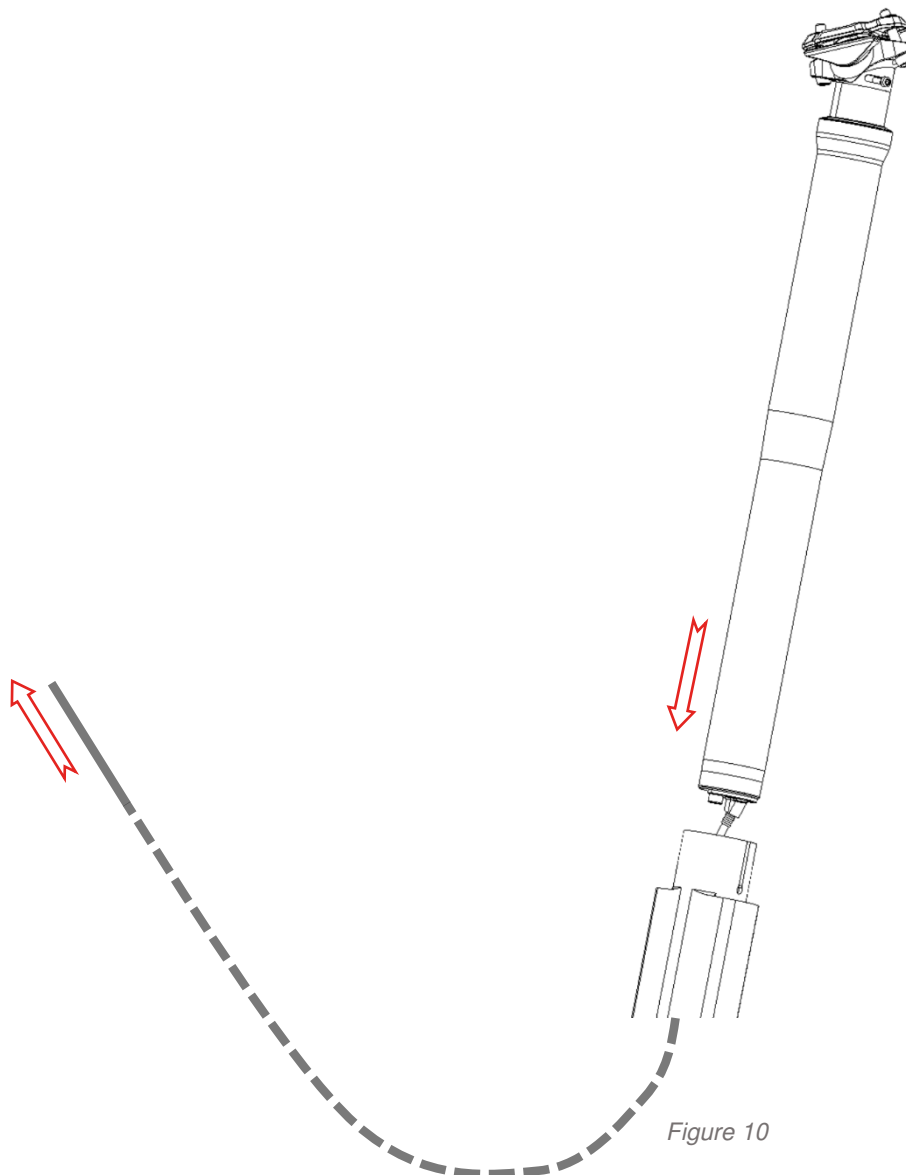

Figure 10

Clamp the seatpost at the desired position. The seatpost may be clamped at a maximum of 35mm above the end of the seat tube.

As the seatpost has integrated height adjustment, the seatpost can usually be fully inserted and clamped in the seat tube.

Only for very tall riders is a higher clamping position necessary!

Caution! Do not overtighten the seat clamp, as this may impair the function of the seatpost.

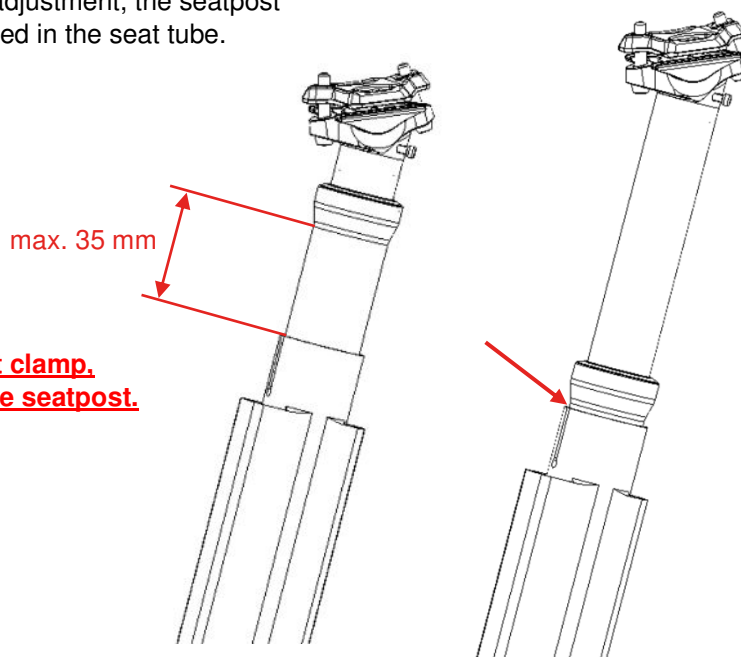

Figure 11

Saddle Installation

Loosen the front and rear fastening screws of the saddle clamp using a 5mm Allen key.

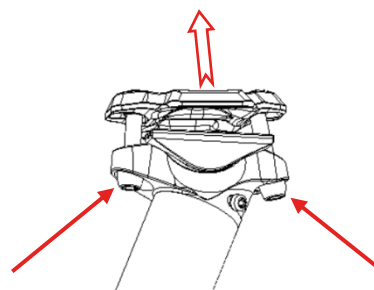

Figure 12

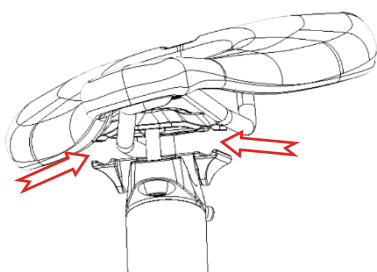

Illustration 13

Insert the upper saddle clamping plate between the two rails of the saddle frame and position it above the two saddle rails.

Let the two rails of the saddle frame rest on the guides of the lower saddle clamping plate. Align the saddle horizontally and tighten the front and rear fastening screws of the saddle clamp with a 5mm Allen key to a maximum torque of 8 Nm.

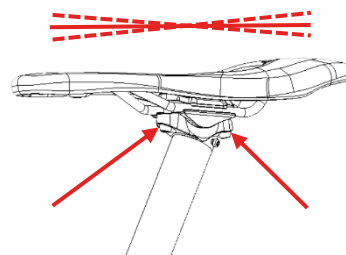

Figure 14

Caution! The nut that tensions the upper saddle plate has a specific alignment. The two flat surfaces must be aligned according to the slot of the upper saddle clamping plate to prevent the nut from turning.

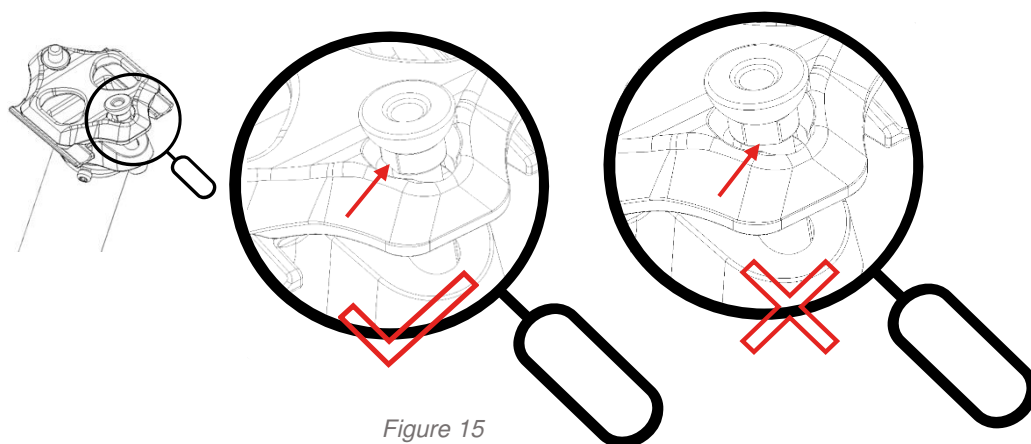

Figure 15

Adjusting Saddle Tilt

Loosen one of the fastening screws on the seatpost head using a 5mm Allen key.

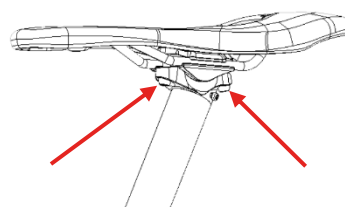

Figure 16

Tilt the saddle forward or backward using the fastening screws.
Loosening the front screw and tightening the rear screw will tilt the saddle nose upwards.
Loosening the rear screw and tightening the front screw will tilt the saddle nose downwards.

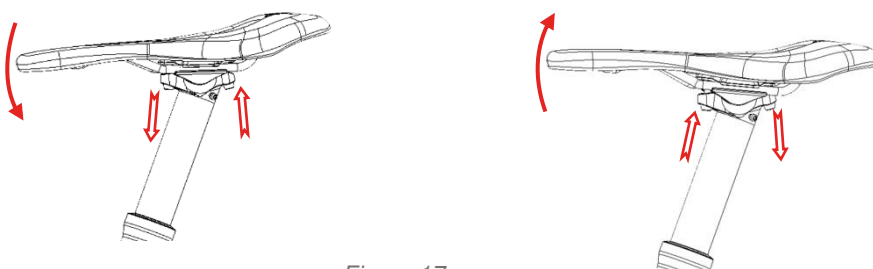

Figure 17

Set the desired saddle tilt and tighten both the front and rear fastening screws to a maximum torque of 8 Nm using a 5mm Allen key.

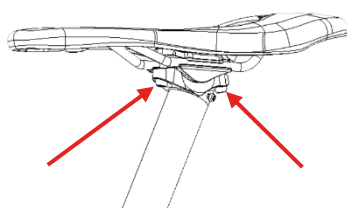

Figure 18

Operation

Adjusting Saddle Height

The Eightpins CARGO 40 seatpost head contains a height adjustment actuator, which is used to set the maximum extension height of the seatpost.

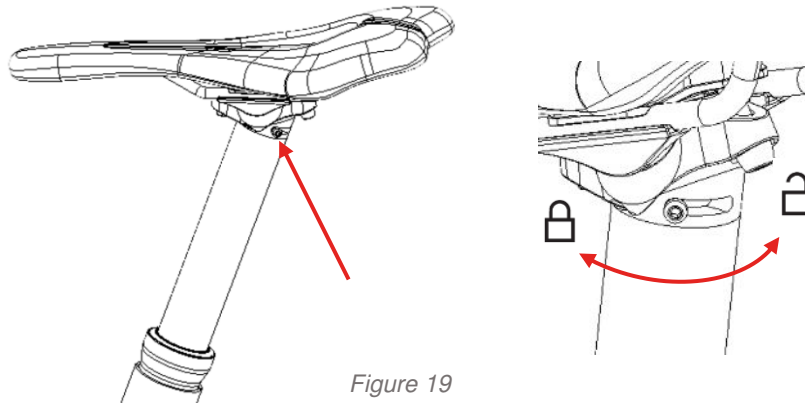

Figure 19

Lowering the maximum extension height:

During a test ride, use the remote lever to lower the seatpost to the desired height while riding.

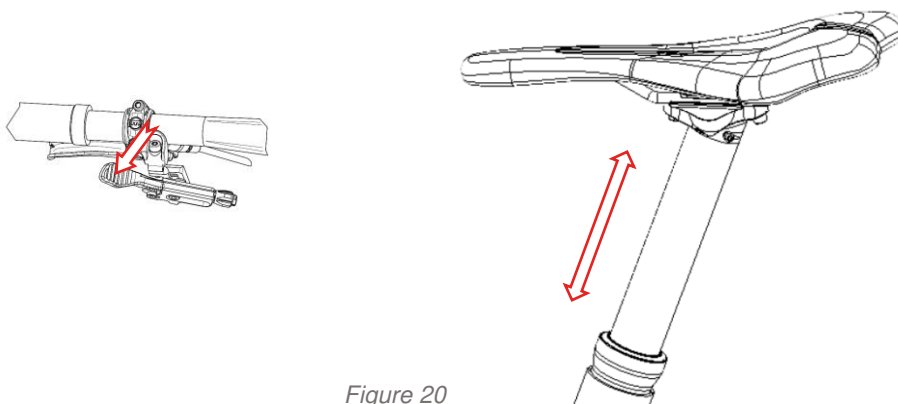

Figure 20

Once the correct height is found, leave the saddle at this height and dismount the bike. Then rotate the height adjustment actuator 45° counterclockwise to the "open position." You will hear the piston rod inside the seatpost moving upward.

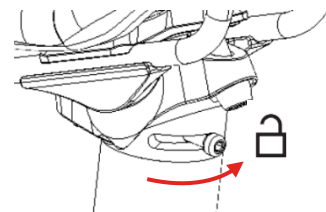

Figure 21

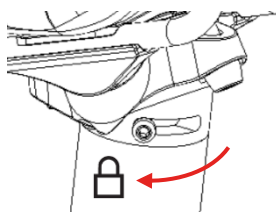

Figure 22

Then turn the actuator 45° clockwise to the "closed position."

ATTENTION: It is important that the height adjustment mechanism is always engaged when riding. This means that it is always turned 45° from the stop to the stop when it engages. If the mechanism jams, simply move the seat post tube up and down very slightly until the seat post tube is firmly engaged. Then close the height adjustment actuator again.

Raising the maximum extension height:

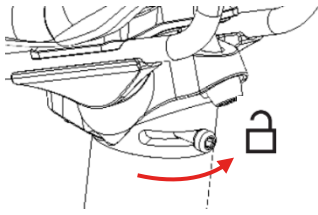

Figure 23

Rotate the height adjustment actuator 45° counterclockwise to the "open position."

While simultaneously pressing the remote lever, pull the seatpost upward by hand to the desired height. Release the lever and press the seatpost slightly up or down until the locking mechanism engages.

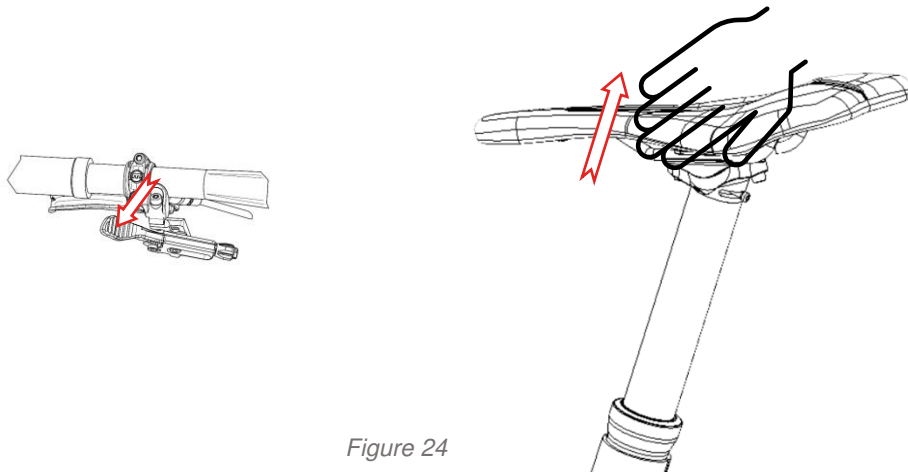

Figure 24

Caution! The seatpost can also be pulled out too far.

You can feel it immediately if the seatpost has been pulled out too far as it is no longer guided through the lower sliding guide. The seatpost then wobbles a lot or has a lot of play. If this happens, simply press the operating lever and carefully push the seat post downwards. When it re-enters the lower bushing, you will feel a slight resistance. Then release the operating lever and push the seat post down slightly. The seat post then locks back into the top position.

Then rotate the actuator 45° clockwise to the "closed position."

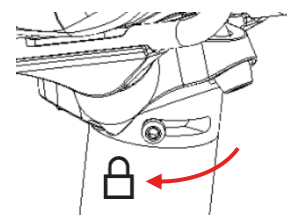

Figure 25

ATTENTION: It is important that the height adjustment mechanism is always engaged when riding. This means that it is always turned 45° from the stop to the stop when it engages. If the mechanism jams, simply move the seat post tube up and down very slightly until the seat post tube is firmly engaged. Then close the height adjustment actuator again.

Adjusting the lowest position lower

If the seatpost height is still too high at its lowest setting, it can be further lowered by 24mm using the built-in stroke reduction of the gas spring.

Fully extend the seatpost, rotate the actuator 45° counterclockwise to the "open position,"

and pull the seatpost fully out while pressing the remote lever.

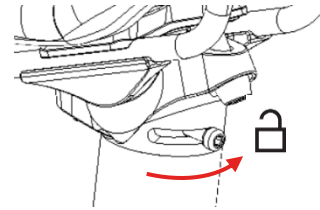

Figure 26

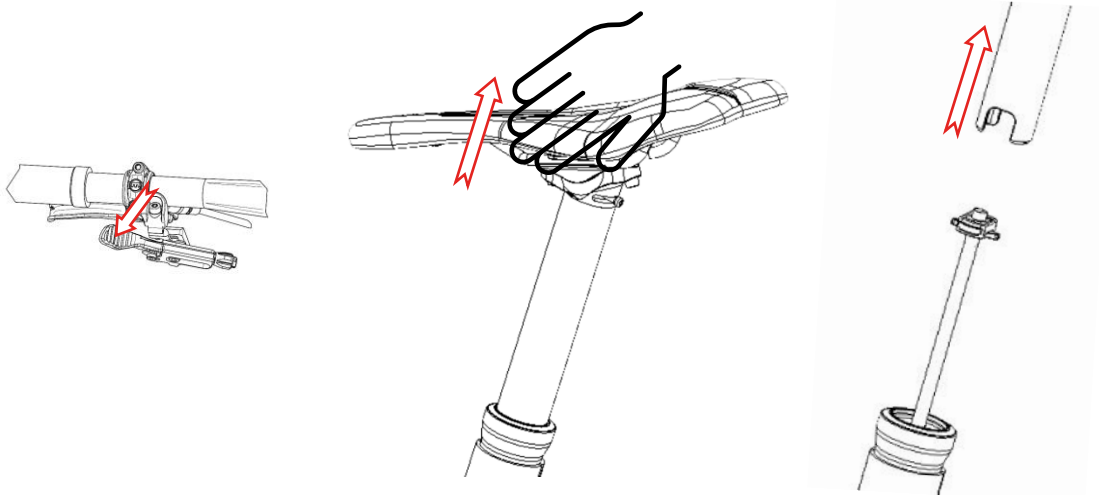

Figure 27

Firmly press the actuator clamp on the piston rod downward by at least 30mm and rotate it 180°. Then release the actuator clamp.

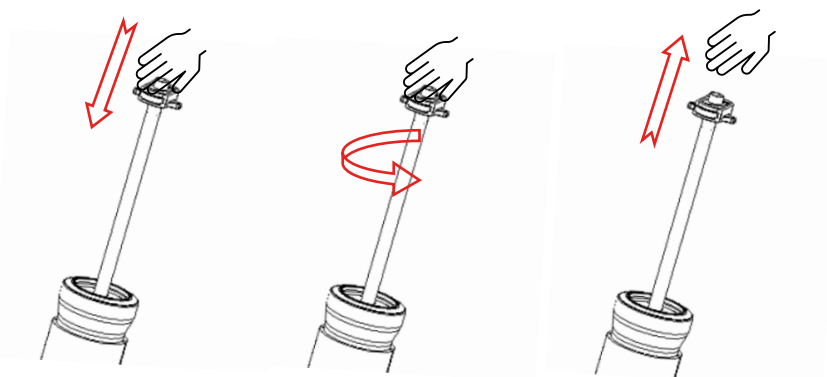

Figure 28

Reinsert the seatpost tube by guiding the actuator clamp back into the tube, ensuring the guide slots align correctly.

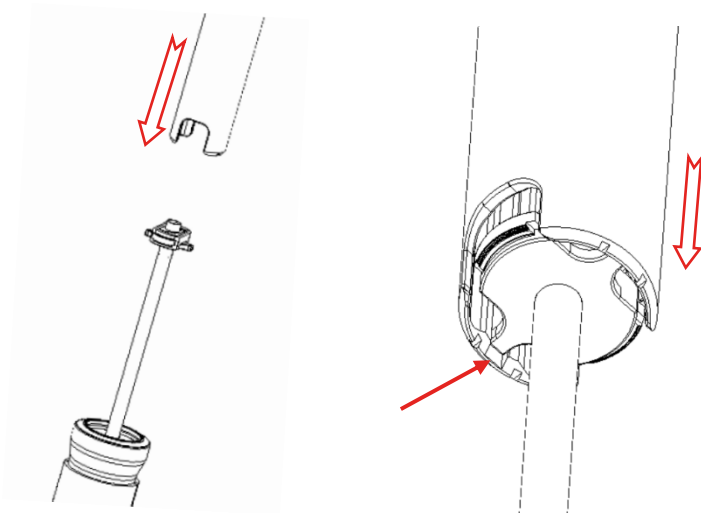
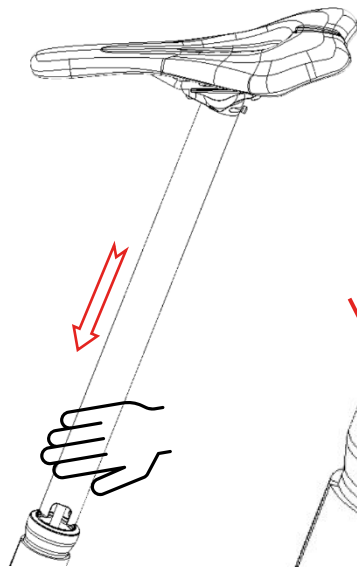

Figure 29



Carefully lower the seatpost tube and guide it into the wiper. Be careful when inserting the seat post into the two bushes; if the resistance is too high, check that the seat post is inserted centrally and at the correct angle!

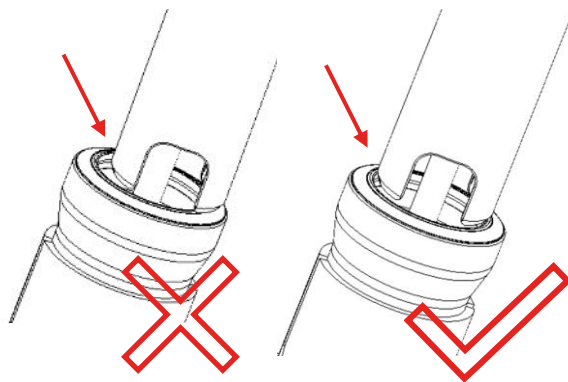

Figure 30

Caution! Do not allow the seatpost tube to collide with the piston rod to avoid scratches or damage, which can cause air leaks and void the warranty!

Press the remote lever and push the seatpost to the desired lower position.

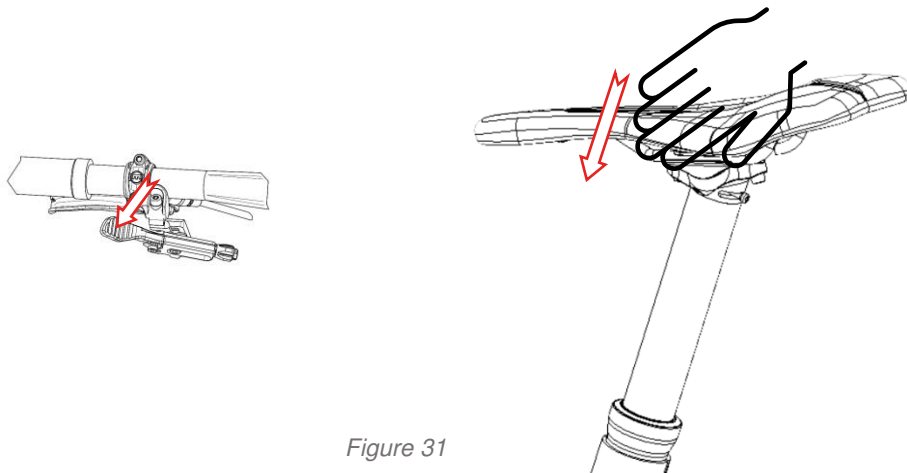

Figure 31

Then rotate the actuator 45° clockwise to the "closed position."

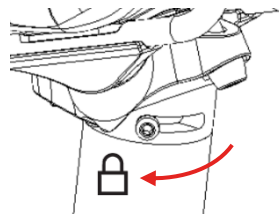

Figure 32

Maintenance

Cleaning the Wiper and Felt Ring

To clean the wiper, fully extend and remove the seatpost tube.

Rotate the actuator 45° counterclockwise to the "open position" and pull out the seatpost tube while pressing the remote lever.

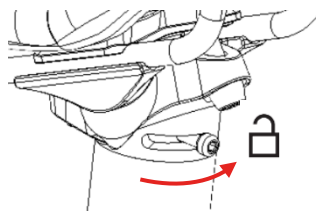

Figure 33

Lift the outer sealing ring sideways and remove it. Carefully pull the wiper out of its groove and remove it.

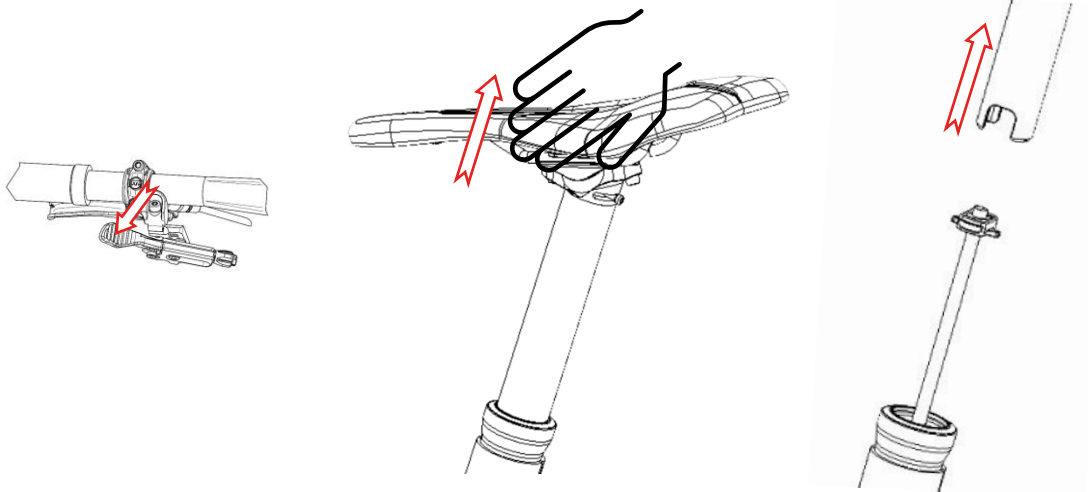
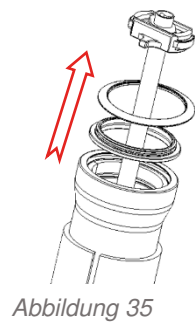

Figure 34



Lift the outer sealing ring sideways and remove it. Carefully pull the wiper out of its groove and remove it.

Use a pointed tool to locate the end of the felt ring, lift it, and carefully remove it.

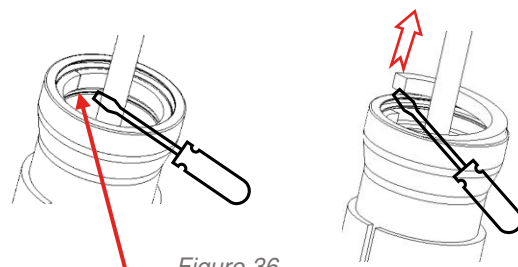

Figure 36

Clean the felt ring, wiper, and sealing ring with a cloth. Replace them if necessary.



Figure 37

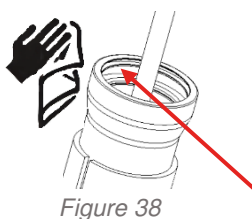

Figure 38

Clean the inside of the outer tube with a cloth.

Reinsert the dry felt ring into the designated groove inside the outer tube.

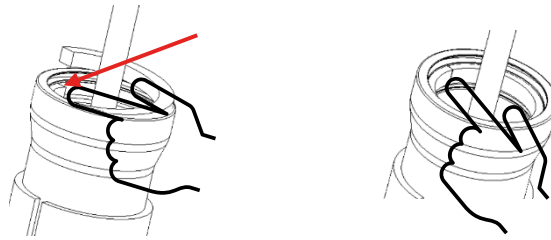

Figure 39

Slowly fill the felt ring with Eightpins Fluid V4 using a 2.5ml syringe. It is best to place the opening of the syringe on the felt ring in several places.

Caution! Do not exceed 2.5ml to prevent overflow.

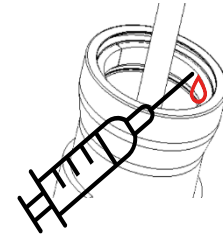

Figure 40

Precautions when handling oil:

- Wear suitable rubber gloves and safety goggles.
- H241: Heating may cause fire or explosion.
- H301: Toxic if swallowed.
- H312: Harmful in contact with skin.
- H315: Causes skin irritation.
- H317: May cause allergic skin reactions.
- H319: Causes serious eye irritation.

Reinsert the cleaned or new wiper into the upper groove and reinstall the outer sealing ring.

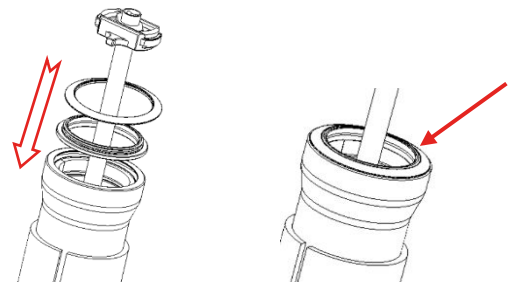

Figure 41

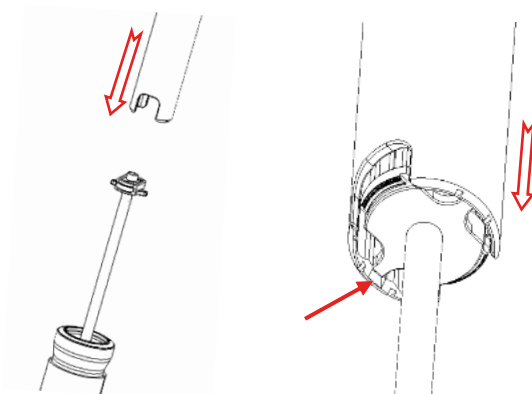

Figure 42

Reinsert the seatpost tube by guiding the actuator clamp back into the tube, ensuring the guide slots align correctly.

Carefully lower the seatpost tube and guide it into the wiper. Be careful when inserting the seat post into the two bushes; if the resistance is too high, check that the seat post is inserted centrally and at the correct angle!

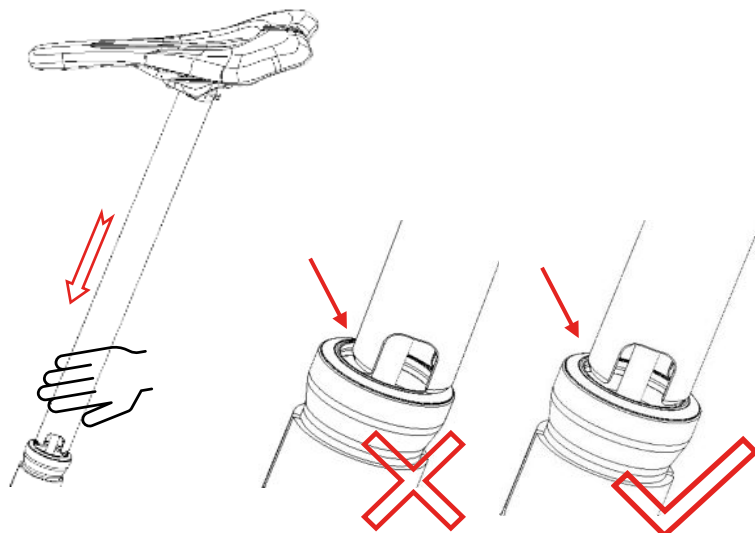

Figure 43

Caution! Do not allow the seatpost tube to collide with the piston rod to avoid scratches or damage, which can cause air leaks and void the warranty!

Press the remote lever and push the seatpost to the desired height.

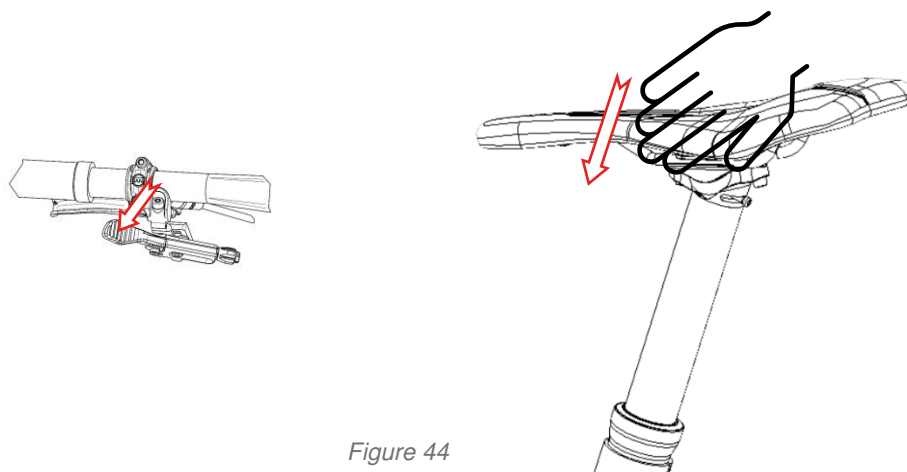

Figure 44

Rotate the actuator 45° clockwise to the "closed position."

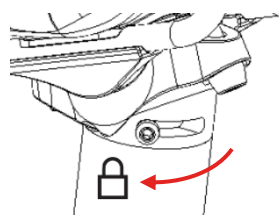

Figure 45